

SITE PLAN

ON

LOT 16, REGISTERED PLAN 1068

IN THE

TOWN of KINGSVILLE

IN THE

COUNTY OF ESSEX. ONTARIO

SCALE 1"= 20'

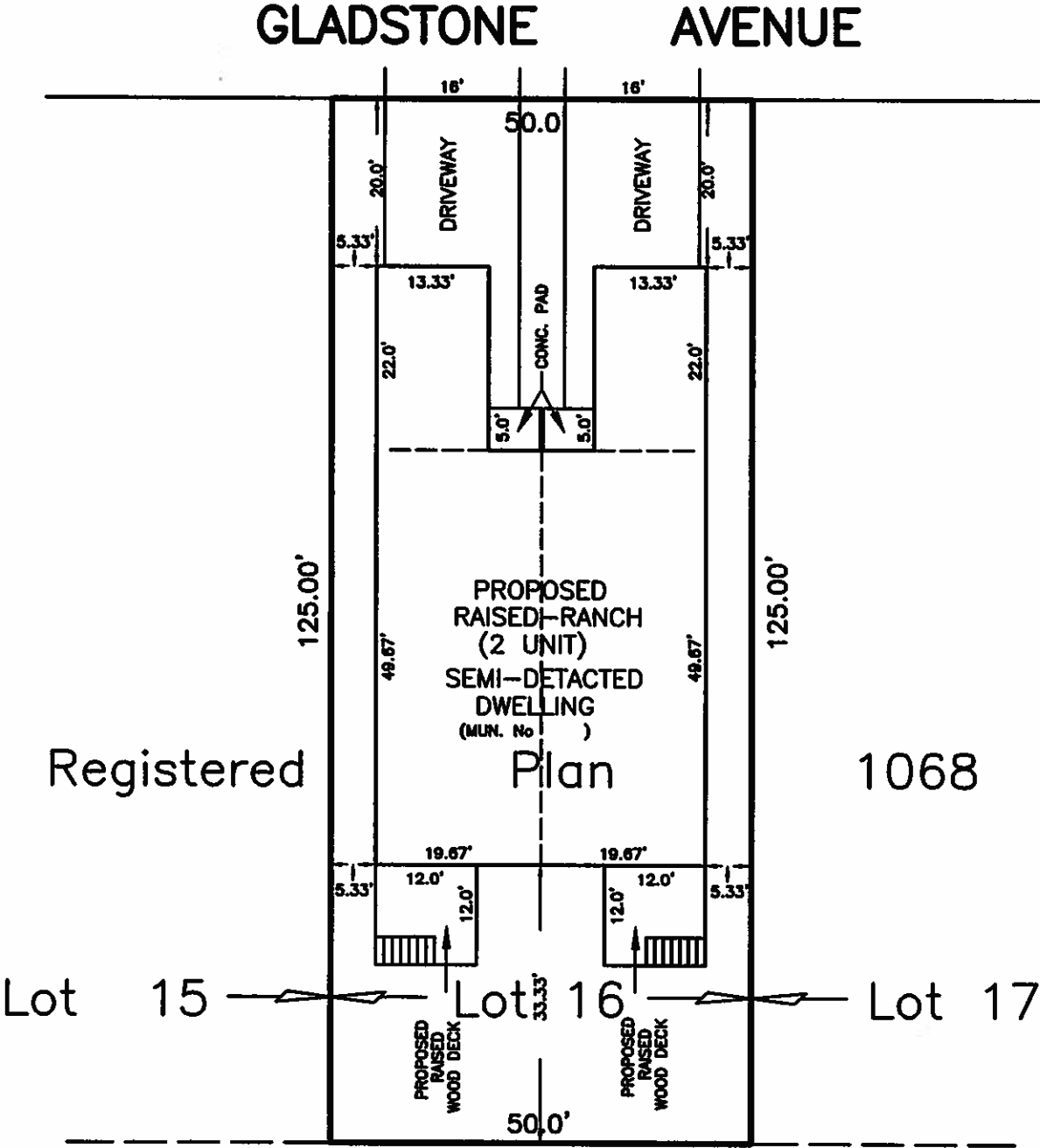

NOTE:

AREA OF LOT = 6250 SQ. FT.  
AREA OF 2 PLEX DWELLING WITH GARAGES = 1270 x 2 = 2540 SQ. FT.  
COVERAGE = 40.64 %  
AREA OF 2 RAISED REAR DECK = 240 SQ. FT.  
COVERAGE = 3.84 %



AUGUST 28, 2017