

# THE CORPORATION OF THE TOWN OF KINGSVILLE

## BY-LAW 30-2023

---

**Being a By-law to amend By-law No. 1-2014,  
the Comprehensive Zoning By-law for the Town of Kingsville**

**WHEREAS** By-law No. 1-2014 is the Town's Comprehensive Zoning By-law to regulate the use of land and the character, location and use of buildings and structures in the Town of Kingsville;

**AND WHEREAS** the Council of the Corporation of the Town of Kingsville deems it expedient and in the best interest of proper planning to further amend By-law No. 1-2014 as herein provided;

**AND WHEREAS** the application conforms to the Official Plan of the Town of Kingsville;

**NOW THEREFORE THE COUNCIL OF THE CORPORATION OF THE TOWN OF KINGSVILLE ENACTS AS FOLLOWS:**

1. Schedule "A", Map 25 of By-law 1-2014 is hereby amended by changing the zone symbol on an approximately 5.67 ha (14 ac.) portion of land, known municipally as 614 County Road 8, in Part of Lot 19, Concession 11, as shown on Schedule 'A' in cross-hatch attached hereto from 'Agriculture (A1)' to 'Agriculture - Restricted (A2)'.
2. This by-law shall come into force and take effect from the date of passing by Council and in accordance with Section 34 of the Planning Act.

**READ A FIRST, SECOND AND THIRD TIME AND FINALLY PASSED THIS 24<sup>th</sup> DAY OF APRIL, 2023.**

---

**MAYOR, Dennis Rogers**

---

**CLERK, Paula Parker**

# Schedule A

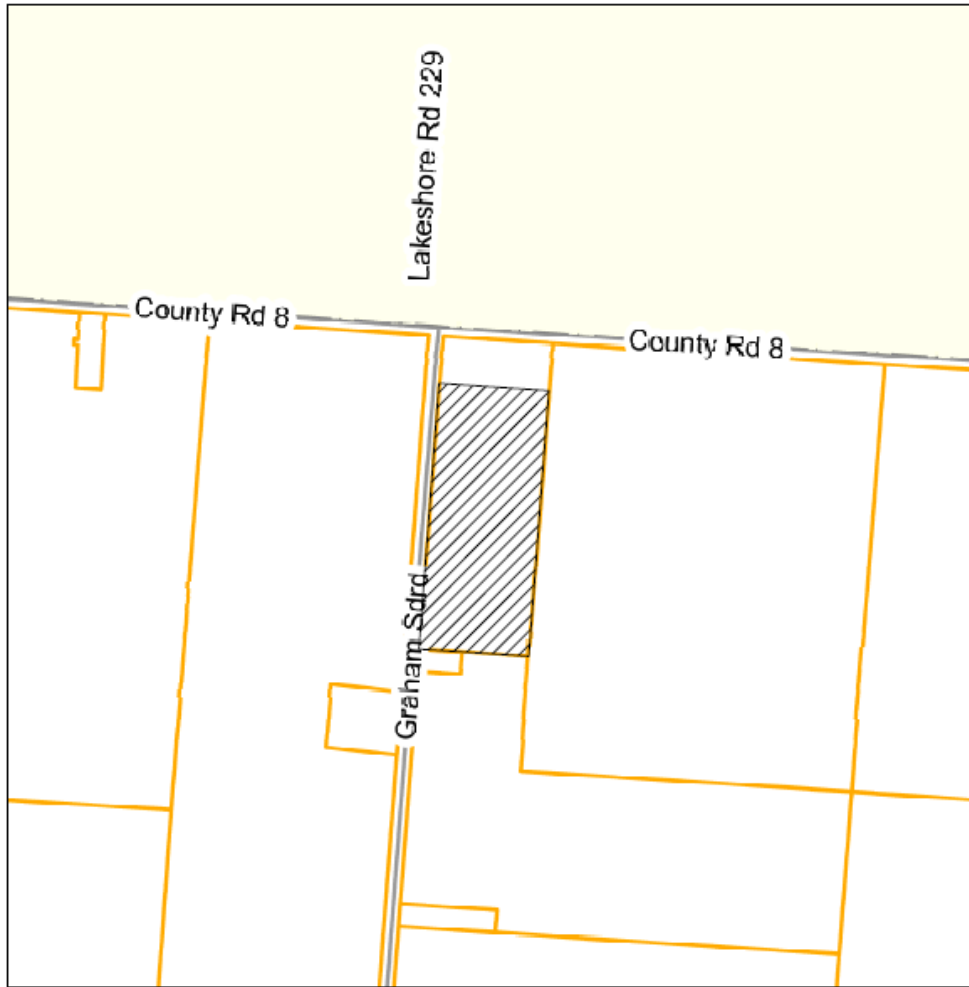

**614 County Road 8**  
**Part of Lot 19, Concession 11**  
**ZBA-2023-07**

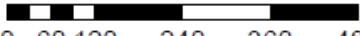
 Meters  
0 60 120 240 360 480

 Schedule "A", Map 25 of By-law 1-2014 is hereby amended by changing the zone symbol as shown on Schedule 'A' in cross-hatch attached hereto from 'Agriculture (A1)' to 'Agriculture - Restricted (A2)'