

THE CORPORATION OF THE TOWN OF KINGSVILLE

BY-LAW 26-2023

**Being a By-law to amend By-law No. 1-2014,
the Comprehensive Zoning By-law for the Town of Kingsville**

WHEREAS By-law No. 1-2014 is the Town's Comprehensive Zoning By-law to regulate the use of land and the character, location and use of buildings and structures in the Town of Kingsville;

AND WHEREAS the Council of the Corporation of the Town of Kingsville deems it expedient and in the best interest of proper planning to further amend By-law No. 1-2014 as herein provided;

AND WHEREAS the application conforms to the Official Plan of the Town of Kingsville;

NOW THEREFORE THE COUNCIL OF THE CORPORATION OF THE TOWN OF KINGSVILLE ENACTS AS FOLLOWS:

1. Subsection 7.1(e) AGRICULTURAL EXCEPTION REGULATIONS is amended with the addition of the following new subsection:

7.1.81 'AGRICULTURE EXCEPTION 81 (A1-81)'

For lands shown as A1-81 on Map 5 on Schedule "A" of this By-law.

Notwithstanding any other provision of the by-law to the contrary the following shall apply to lands zoned A1-81:

- i) *Minimum lot area* shall be 0.77 ha (1.9 ac.).
 - ii) *A Contractor's yard, office and shop* is permitted as a Main Use.
2. Schedule "A", Map 5 of By-law 1-2014 is hereby amended by changing the zone symbol on an approximately 0.77 ha (1.9 ac.) portion of land, known municipally as VL County Road 34 West, in Part of Lot 273, Concession North Talbot Road, as shown on Schedule 'A' in cross-hatch attached hereto from 'Agriculture (A1)' to 'Agriculture Exemption 81 (A1-81)'.
 3. This by-law shall come into force and take effect from the date of passing by Council and in accordance with Section 34 of the Planning Act.

**READ A FIRST, SECOND AND THIRD TIME AND FINALLY PASSED THIS
11th DAY OF APRIL, 2023.**

MAYOR, Dennis Rogers

CLERK, Paula Parker

Schedule A

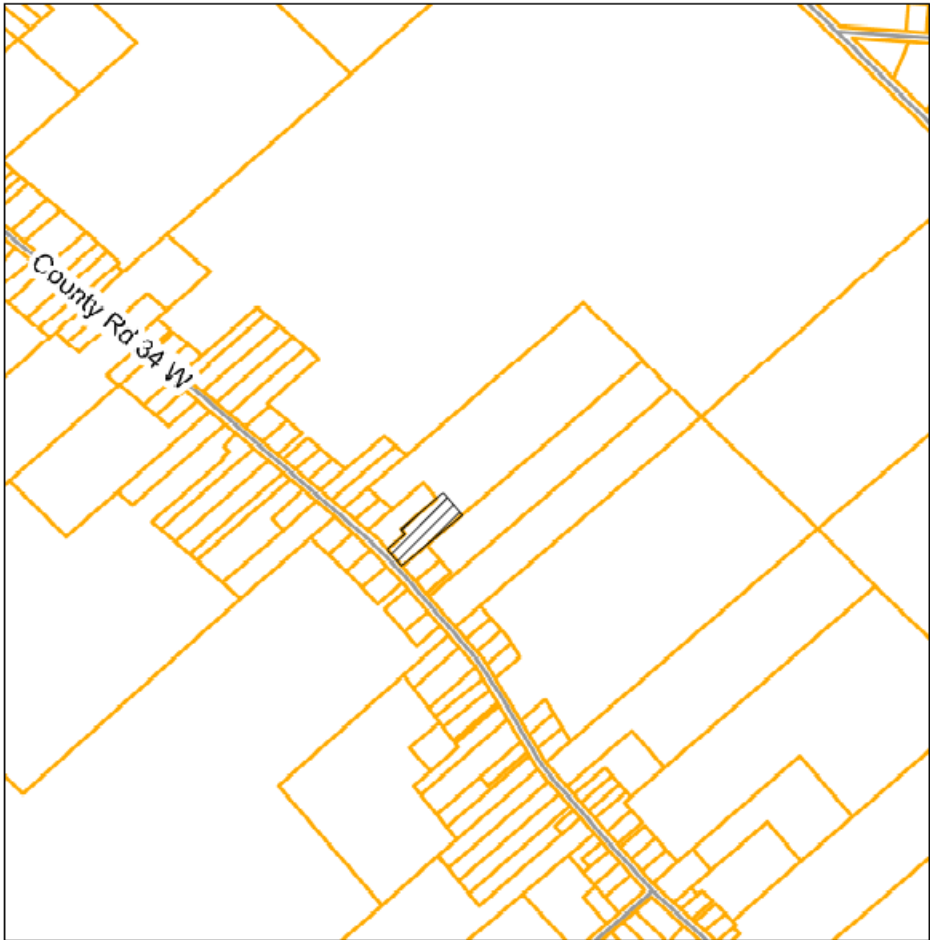

VL County Road 34 W
Part Lot 273, Concession North Talbot Rd
ZBA-2023-05

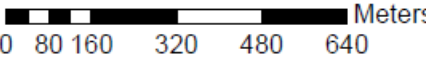

 Schedule "A", Map 5 of By-law 1-2014 is hereby amended by changing the zone symbol as shown on Schedule 'A' in cross-hatch attached hereto from 'Agriculture (A1)' to 'Agriculture Exemption 81 (A1-81)'