

THE CORPORATION OF THE TOWN OF KINGSVILLE

BY-LAW 115-2018

Being a By-law to amend By-law No. 1-2014, the Comprehensive Zoning By-law for the Town of Kingsville

WHEREAS By-law No. 1-2014 is the Town's Comprehensive Zoning By-law to regulate the use of land and the character, location and use of buildings and structures in the Town of Kingsville;

AND WHEREAS the Council of the Corporation of the Town of Kingsville deems it expedient and in the best interest of proper planning to further amend By-law No. 1-2014 as herein provided;

AND WHEREAS there is an Official Plan in effect in the Town of Kingsville and this By-law is deemed to be in conformity with the Town of Kingsville Official Plan;

NOW THEREFORE THE COUNCIL FOR THE CORPORATION OF THE TOWN OF KINGSVILLE ENACTS AS FOLLOWS:

1. That Subsection 7.1 e) AGRICULTURE ZONE 1 A1 EXCEPTIONS is amended with the addition of the following new subsection:

7.1.76 'AGRICULTURE ZONE 1 EXCEPTION 76 (A1-76)'

- a) For lands shown as A1-76 on Map 60 Schedule "A" of this By-law.
- b) **Permitted Uses**
 - i) Those uses permitted under Section 7.1;
 - ii) A medical marihuana production facility (MMPF)
- c) **Permitted Buildings and Structures**
 - i) Those buildings and structures permitted under Section 7.1 in the (A1) zone;
 - ii) Buildings and structures accessory to the permitted uses.
- d) **Zone Provisions**

All lot and building requirements for the permitted buildings and structures shall be in accordance with Section 7.1 of this By-law.

Notwithstanding Section 4.46 of the by-law to the contrary the following shall apply:

- i) Item c) is deleted and replaced as follows: A residential use accessory to or supportive of the agricultural uses on-site, including a MMPF is permitted
- ii) Items d), e) and i) are not applicable to lands zoned A1-76;

All other items listed under Section 4.46 remain applicable to lands zoned A1-76.

- 2. Schedule "A", Map 60 of By-law 1-2014 is hereby amended by changing the zone symbol on lands known municipally as Part of Lot 7, Concession 1 ED, and locally known as 1660 Graham Side Road as shown on Schedule 'A' cross-hatched attached hereto from 'Agriculture Zone 1 (A1)' to 'Agriculture Zone 1 Exception 76 (A1-76)'.
- 3. This by-law shall come into force and take effect from the date of passing by Council and in accordance with Section 34 of the Planning Act.

READ A FIRST, SECOND AND THIRD TIME AND FINALLY PASSED THIS 9th DAY OF OCTOBER, 2018.

MAYOR, Nelson Santos

CLERK, Jennifer Astrologo

Schedule 'A'

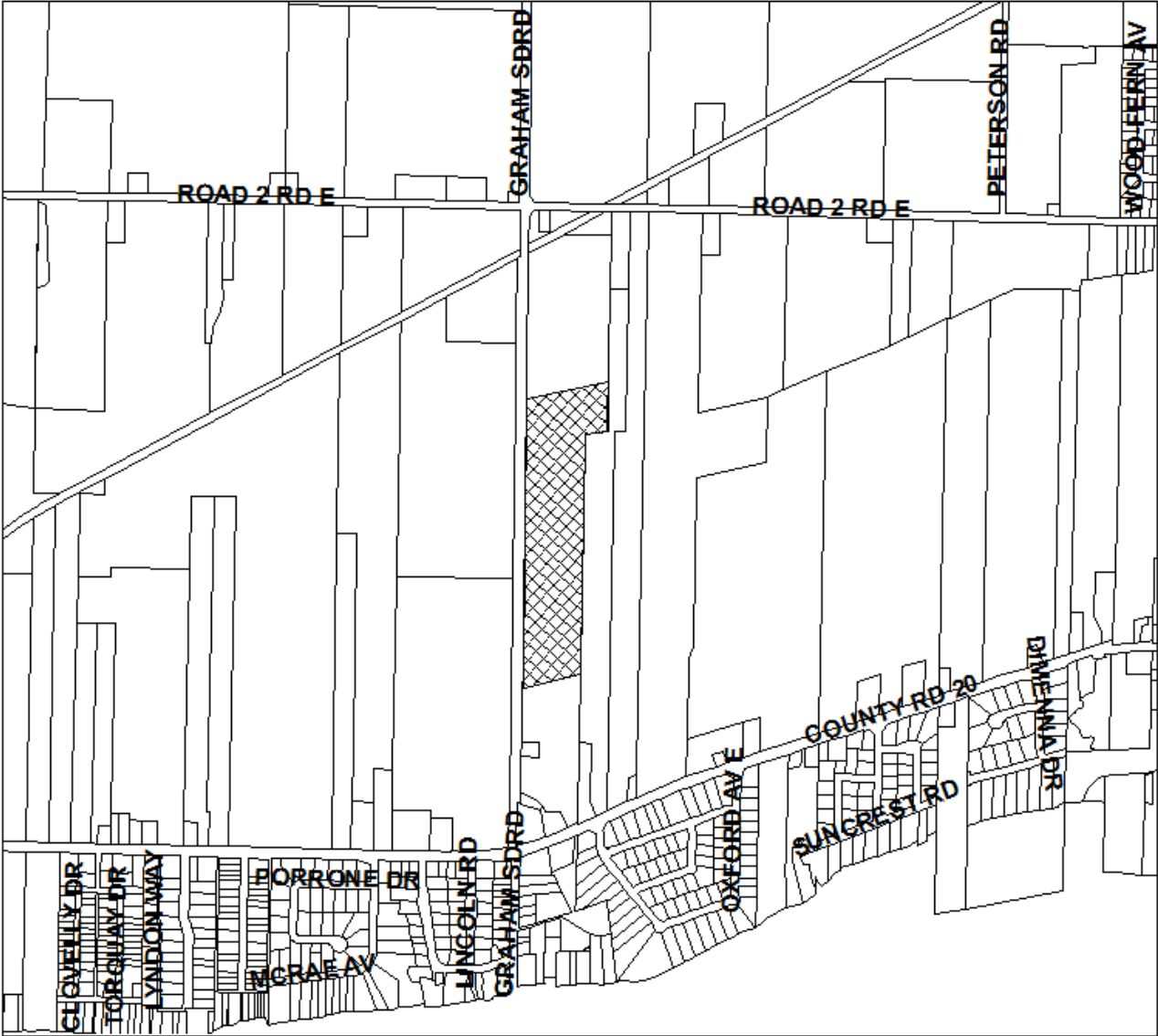

Part of Lot 7, Concession 1 ED
1660 Graham Side Road
Zoning By-law Amendment ZBA/23/18

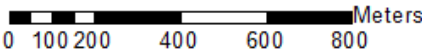

Schedule "A", Map 60 of By-law 1-2014 is hereby amended by changing the zone symbol as shown on Schedule 'A' in cross-hatch attached hereto from 'Agriculture Zone 1 (A1)' to 'Agriculture Zone 1 Exception 76 (A1-76)'